

## 16.Front Accessory Power Supply Socket

### A: WIRING DIAGRAM

Refer to “Front Accessory Power Supply Socket System” in the wiring diagram. <Ref. to WI-237, WIRING DIAGRAM, Front Accessory Power Supply Socket System.>

### B: REMOVAL

1) Disconnect the ground cable from battery. <Ref. to NT-5, BATTERY, NOTE, Note.>

NOTE:

For models other than STI model, disconnect the ground terminal from battery sensor.

2) Remove the panel center assembly. <Ref. to EI-66, REMOVAL, Center Console.>

3) Remove the socket assembly.

(1) Disconnect the connector.

(2) While releasing the claw inside, press it in from the rear to remove the socket assembly.

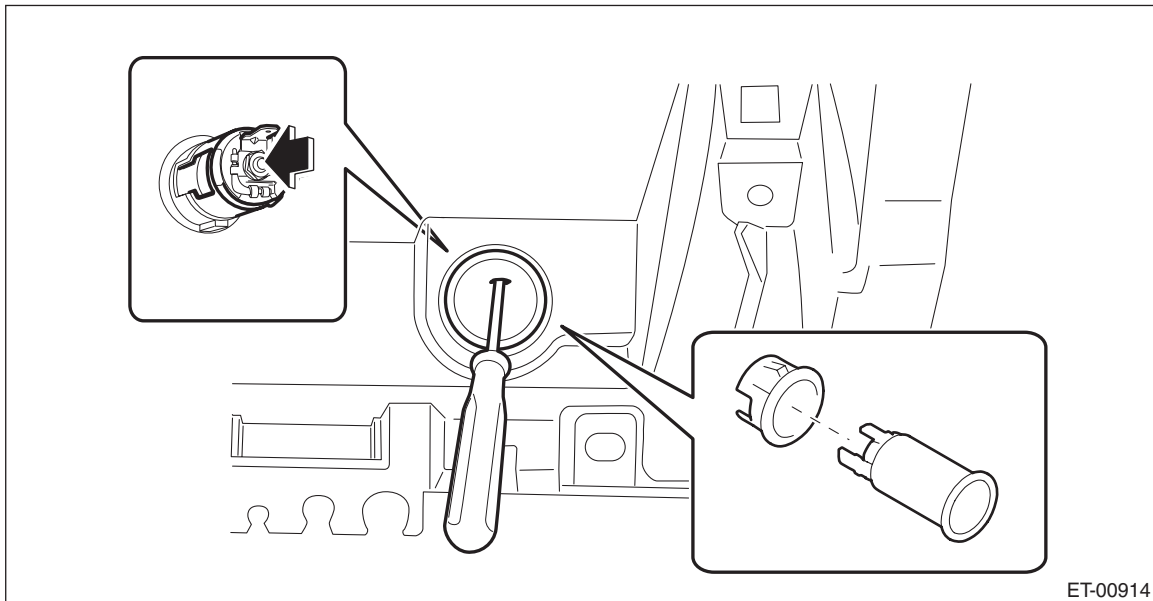

(3) Remove the clip - socket.

# Front Accessory Power Supply Socket

ENTERTAINMENT

---

## C: INSTALLATION

### CAUTION:

**After installing the panel center assembly, check that the air vent grille of the panel center assembly is inserted correctly into the air vent duct.**

- 1) Install the clip - socket.
- 2) Install the socket assembly.

### NOTE:

Align the groove of the clip - socket with the claw of the socket assembly.

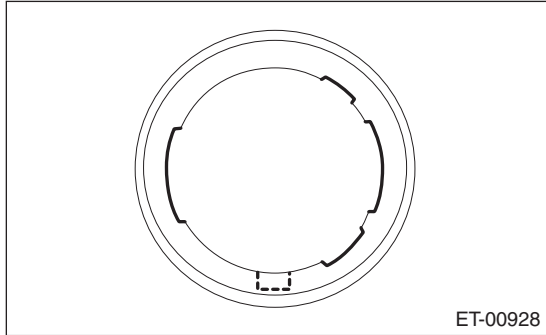

- 3) Install the panel center assembly.
- 4) Connect the battery ground terminal. <Ref. to NT-5, BATTERY, NOTE, Note.>

### NOTE:

For models other than STI model, connect the ground terminal to battery sensor.